

ALTON SCHOOL MASTER PLAN

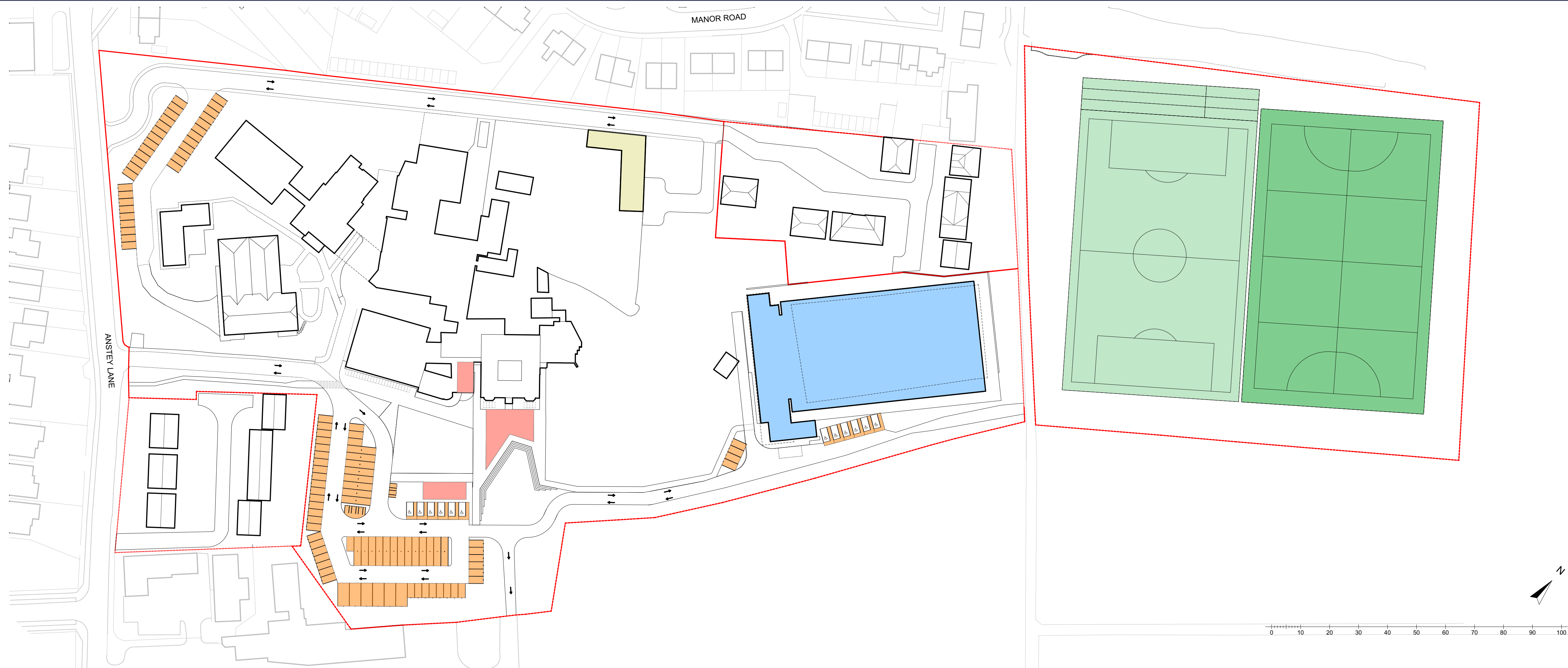

BRIEF

To develop new school facilities and spaces within a redesigned site that connects disparate spaces, embraces the landscape, and combines traditional elements with contemporary uses.

Key principles:-

- A new focal point for the school and the local community
- New teaching spaces
- New sports facilities
- Provide facilities for the wider community to use and enjoy
- New meeting spaces
- Improved and expanded car parking.

PHASE 1

VEHICLE PARKING

Redesigned car park with increased capacity:-

- 30 additional parking spaces (from 109 to 139)
- 30 cycle spaces
- 5 spaces for motorised 2 wheel vehicles
- 2 charging points for electric vehicles

SCHOOL SQUARE

Formal setting in front of the Manor House:-

- Provides central meeting place and focal point for the school
- Restores entrance of the school to the Manor House
- Restores Manor House as the heart of the school
- New Cafe forms part of the square
- Concentrates access points to the school which improves security and encourages interaction

SCHOOL CAFE

New social hub offering snacks and drinks to sixth form students, staff, parents and visitors:-

- Open to the local community
- Welcoming space for people to meet and talk in an informal setting
- Vista onto square

SPORTS CENTRE

New indoor sports centre providing:-

- Indoor courts for a large variety of sports
- Available for community use after school hours and at weekends
- Disabled access
- Changing rooms and storage
- Teaching space
- Reception area

PHASE 2

SPORTS PITCHES

Redesigned sports pitches providing:-

- Floodlit artificial sports pitch
- Grass sports pitch
- Cricket Nets
- Available for community use after school hours and at weekends

SISTERS' RESIDENCE

New accommodation suitable for the elderly Convent Sisters' needs

- Low energy dwelling
- Enables Manor House to be used as an additional teaching and staff space

